



LED Hub Handbook



TABLE OF CONTENTS PART I – BASICS

1. Charging.....	1
2. USB-Connection.....	1
3. 0% SoC	1
4. Warning	2
5. Error.....	2
6. Decreasing Power from Drive Unit	2
7. BLE Connect.....	3
8. BLE Disconnect	3
9. Welcome Animation	3
10. Power	3
11. Walk Assist Active	4
12. Boost.....	4



Applicable for RIDE 60 Firmware 006 and onwards!

1. Charging

State of Charge (SoC) is shown in color of chosen support mode

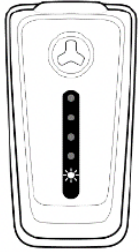

SOC < 20%

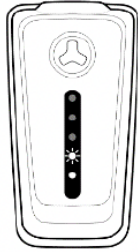

20% < SOC < 40%

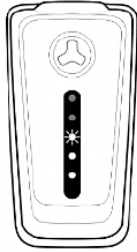

40% < SOC < 60%

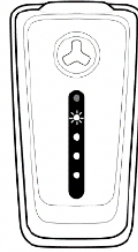

60% < SOC < 80%

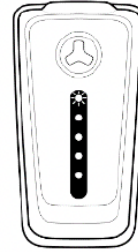

80% < SOC < 100%

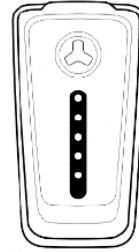

SOC = 100%

2. USB-Connection

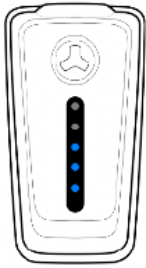

Battery inserted
Shows SoC + Support Mode

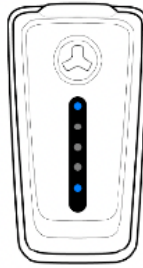

Battery missing
Shows Support Mode +
Missing Battery Indication

3. 0% SoC

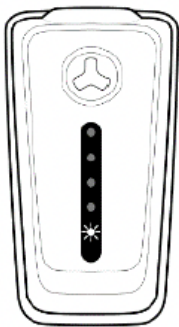

2x



4. Warning

Technical impairment, that requires rider attention, but doesn't necessarily impede operation of the DRIVE UNIT. (Possible to be fixed by the rider.)

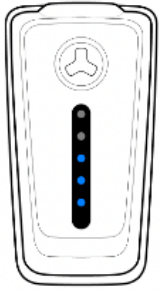

Current SoC in
chosen support mode



2x



every 10s

5. Error

Technical impairment, that prevents operation of the DRIVE UNIT and requires immediate attention

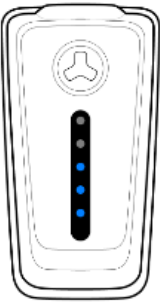

Current SoC in
chosen support mode

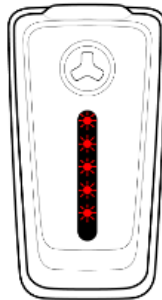

3x



every 2s

6. Decreasing Power from DRIVE UNIT

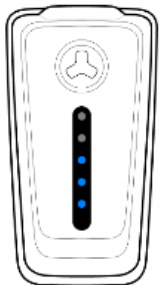

Current SoC in
chosen support mode



Pulse

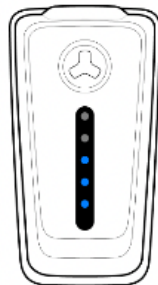

Current SoC in
chosen support mode



Repeat until reason for
derating is eliminated &
no support is selected

7. BLE Connect

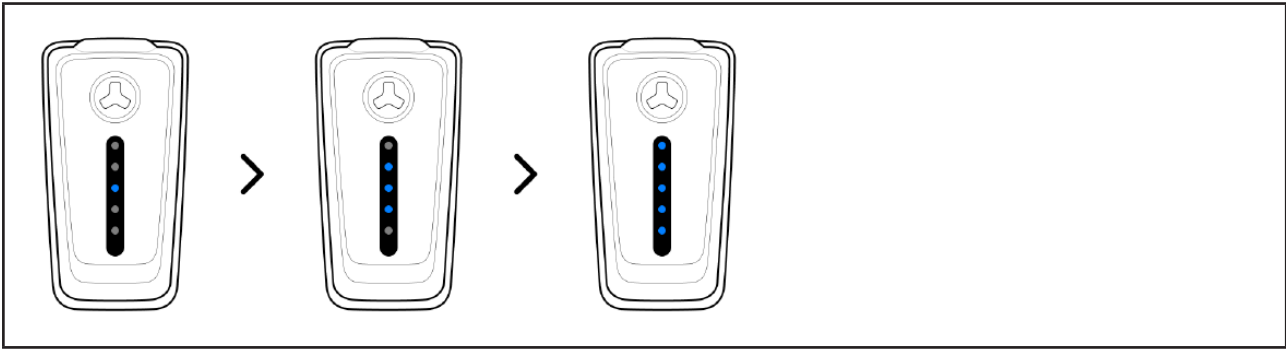

8. BLE Disconnect

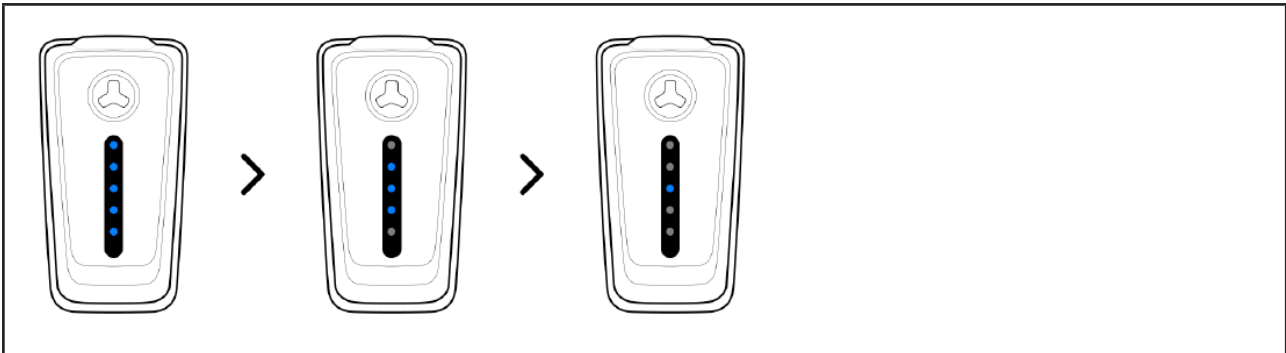

9. Welcome Animation

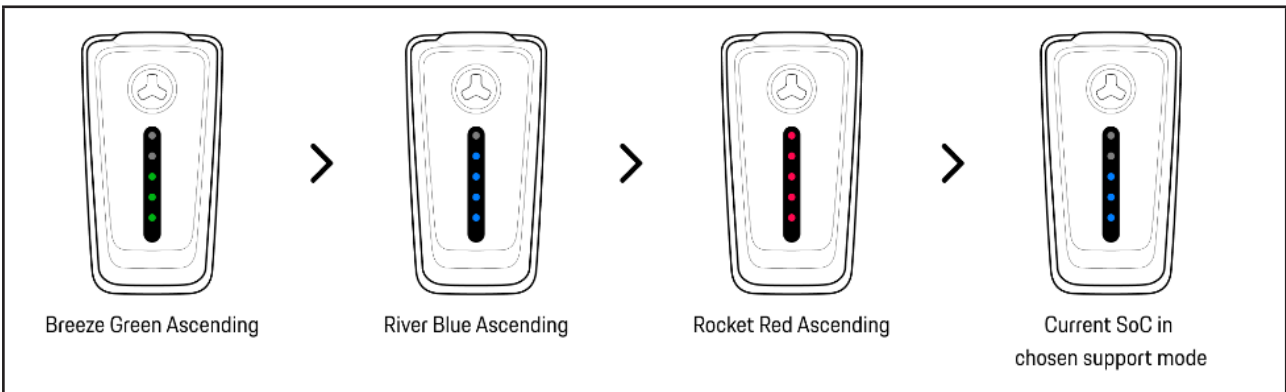

10. Power

Battery wake up caused by: shaking the bike OR putting in the battery OR connecting via USB to a power source

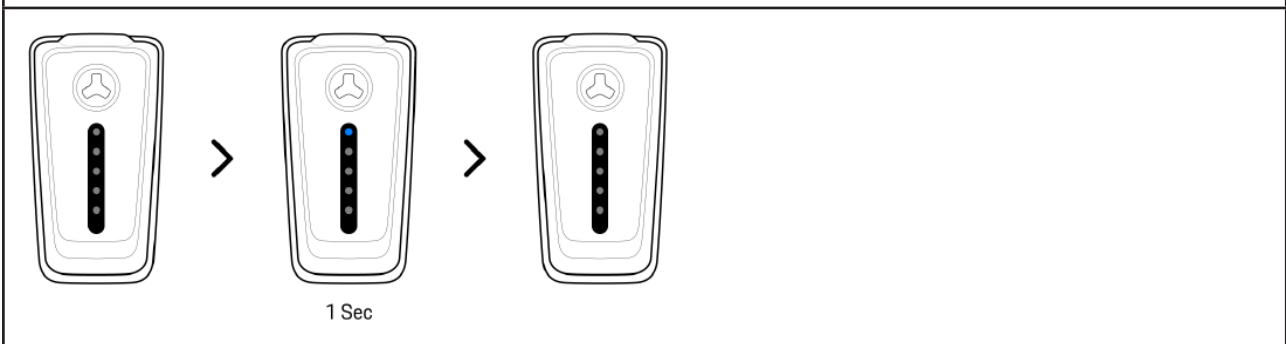

11. Walk Assist Active

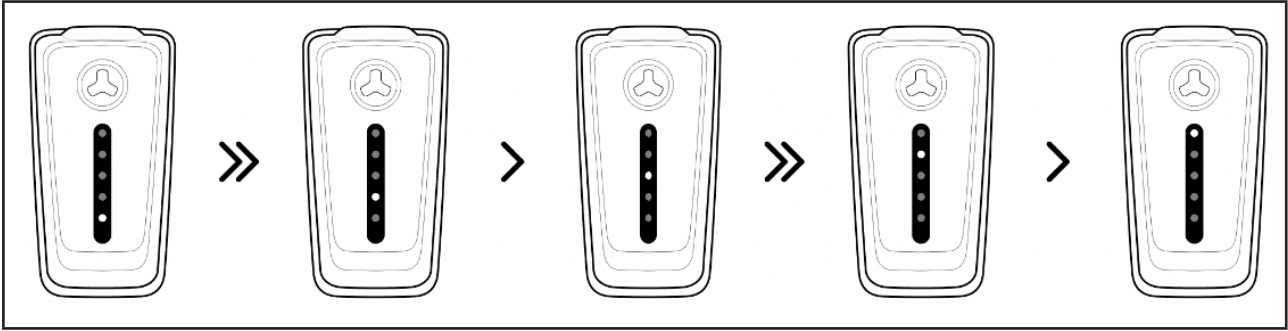

12. Boost

